

# OWNER'S MANUAL



*"No Chrome, No Carbon Fiber, No BS!! Period...."*  
*<http://www.incriminatoraudio.com>*

## **IA40.1**



### **Digital Class-D Linkable Mono Block Amplifier**

Before operating this unit, please read this manual and keep it for future reference

Congratulations, and thank you for your purchase of Incriminator Audio amplifiers.

Like all of IA's products, the 40.1 series amplifier was designed with only one thing in mind.....Performance!

The new 40.1 has been completely redesigned, and comes with many performance upgrades.

The first and major upgrade you will notice when you opened the box should be the new case design.

You may be surprised to see that the new amplifier has grown SMALLER in size.

Don't be alarmed, smaller doesn't always mean less performance.

In fact, IA believes smaller can mean bigger! New technology has allowed us to use fewer and smaller parts on the board and in effect, has allowed the amps to become more efficient using our multi-layering technology to protect themselves better than ever, bullet proof technology is here to stay.

Once again congratulations, and THANK YOU for being a valued Incriminator Audio customer!

Contact us:

Incriminator Audio

2935 Hwy. 101 N

Rogersville, AL 35652

(256) 417-6658

<http://www.incriminatoraudio.com>

## FEATURES & SPECIFICATIONS

- Digital Class-D Linkable Mono Block Amplifier
- Exclusive Bullet Proof Technology Layering
- Daisy-Chain Through Output RCA for Strapping
- 1 ohm Stable and 2 ohms Stable when Strapped
- Dual MOS-FET PWM Power Supplies
- 24 dB Low Pass (LPF) Crossover Variable - 30 Hz to 250 Hz
- 24 dB Subsonic Filter Variable - 10 Hz to 70 Hz (with ON/OFF Selectable Switch)
- Selectable Switch for Master and Slave Operation
- Multi-Layer Protection - Speaker Short, Over Current, Thermal, and DC Protection Circuit
- Line Input and Master Output / Slave Input RCA Connectors
- Heavy Duty Copper Layer Double Sided Epoxy PCB
- 0 Gauge Battery Input Connectors
- 8 Gauge Speaker Output Connectors
- 100% QC Testing and Warm Up
- Efficiency: 86% at 4 ohms, 100 Hz
- Tested Voltage & THD : 14.4V and Less Than 1% THD at 4 ohms RMS Watt
- Operating Voltage: DC 10V ~ 16V Power Input
- Damping Factor: 350+ into 1 ohm
- Input Sensitivity 200mV to 6 Volts
- Rated Power Output RMS:
  - 7200 watts at 2 ohms Linked
  - 3600 watts at 1 ohm
  - 1800 watts at 2 ohms
  - 900 watts at 4 ohms
- Dimensions- 10.00 (W) x 3.07 (H) x 25.19 (L)

## SINGLE AMP RCA CONNECTION

If no sound, please check the MASTER/SLAVE switch. The mode switch should be in MASTER position, if in SLAVE position the unit will not play

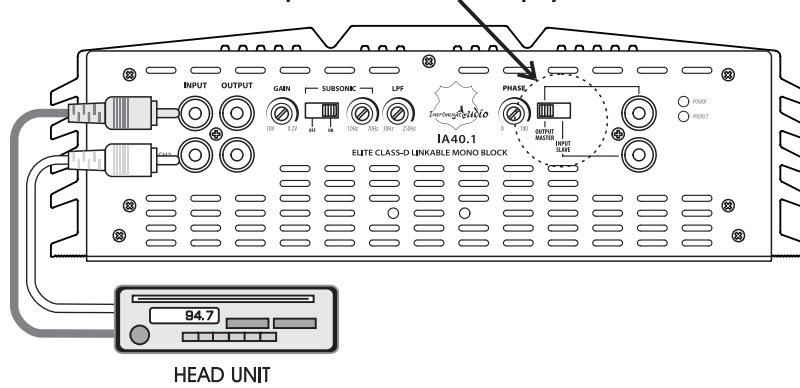

## MASTER & SLAVE RCA CONNECTION

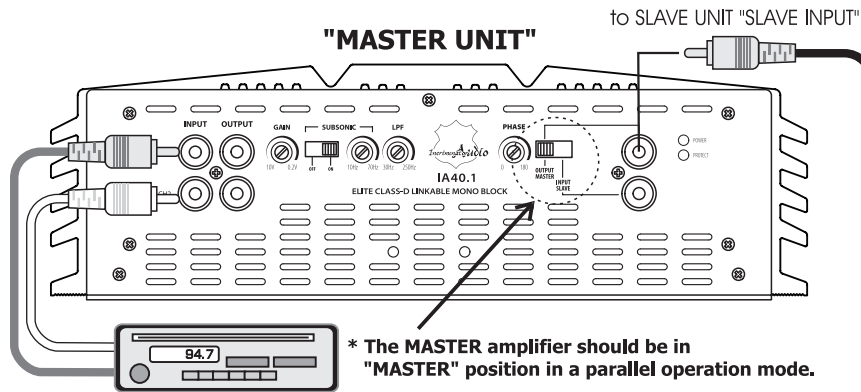

\* The MASTER amplifier should be in "MASTER" position in a parallel operation mode.

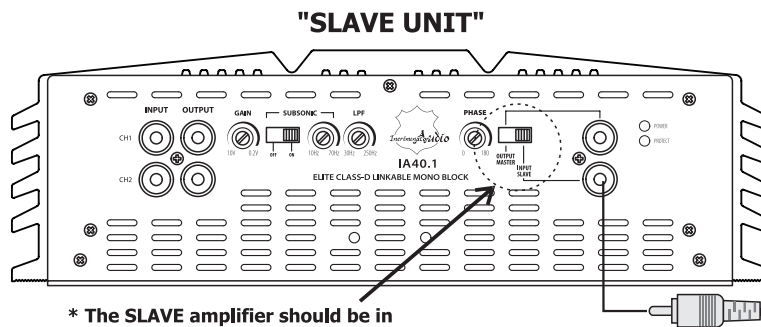

\* The SLAVE amplifier should be in "SLAVE" position in a parallel operation mode.

## POWER CONNECTIONS

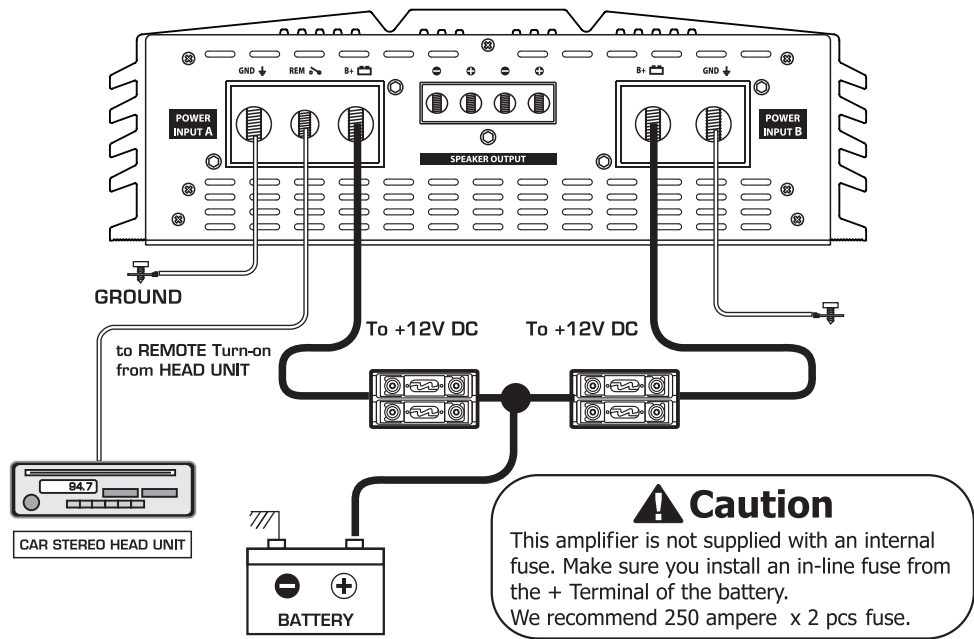

### **+12V Power**

Connect the +12V (B+) terminal of the amplifier to the + terminal of the battery using the same size cable for both the power and ground, we recommend 1/0 gauge wire. Make sure you install a fuse or breaker approximately 12 to 18 inches from the + terminal of the battery. Make sure there is no fuse in-line or the breaker is turned off until installation is complete.

### **GROUND**

Disconnect the battery and connect the (GND) ground terminal to the car frame. Keep this cable as short as possible, not longer than 30 inches. Make sure the connection with the frame is secure and the connection is free of rust and paint.

### **REMOTE**

Connect the REM terminal of the amplifier to the power antenna terminal in the car ignition switch using 12 or 16 ga. electrical wire.

## SINGLE AMP SPEAKER CONNECTION

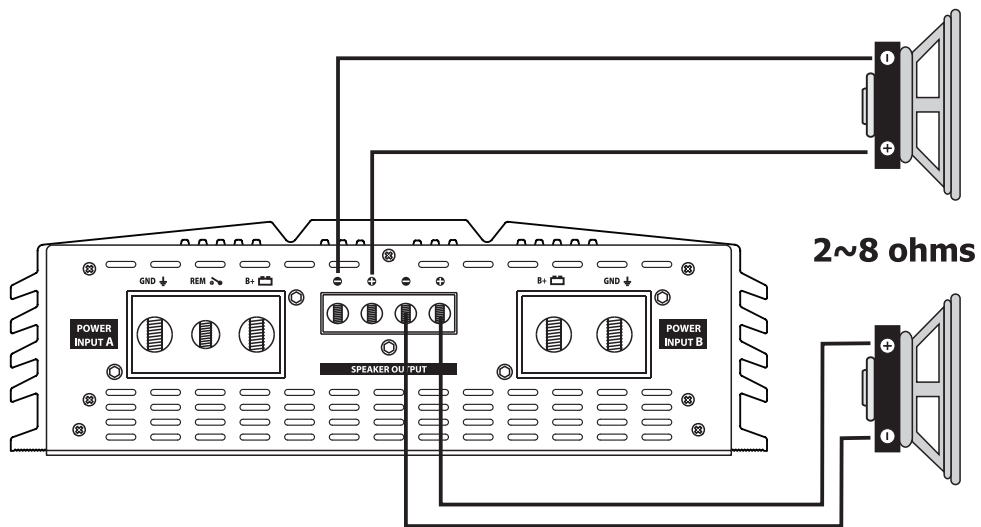
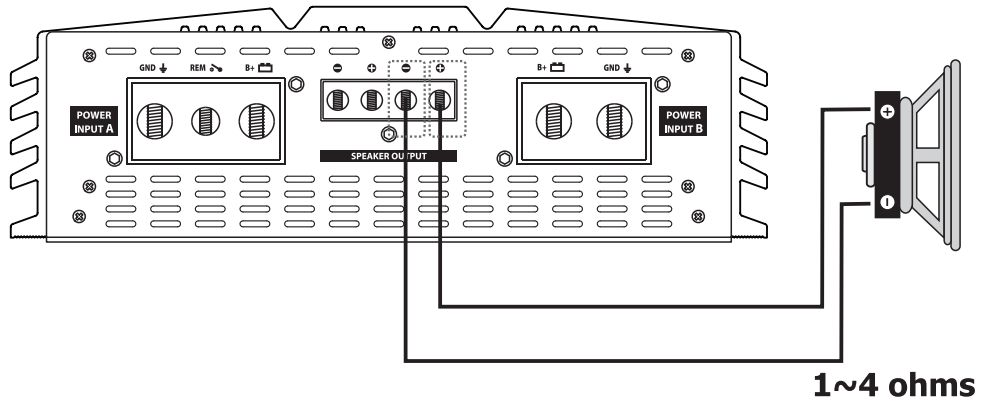

Please note that this unit is a mono block unit and only has one channel. Speaker A and Speaker B are just labeled for clear illustration. Hooking up either the positive or negative of either of the two connections will end in the same result as both positive connection and negative connection are tied together inside the unit. If for example you connect 2 subwoofers that are 2 ohms each the amp will parallel the 2 connection for a 1 ohm load.

## DUAL AMP POWER AND SPEAKER CONNECTION (Linkable)

### "MASTER UNIT"

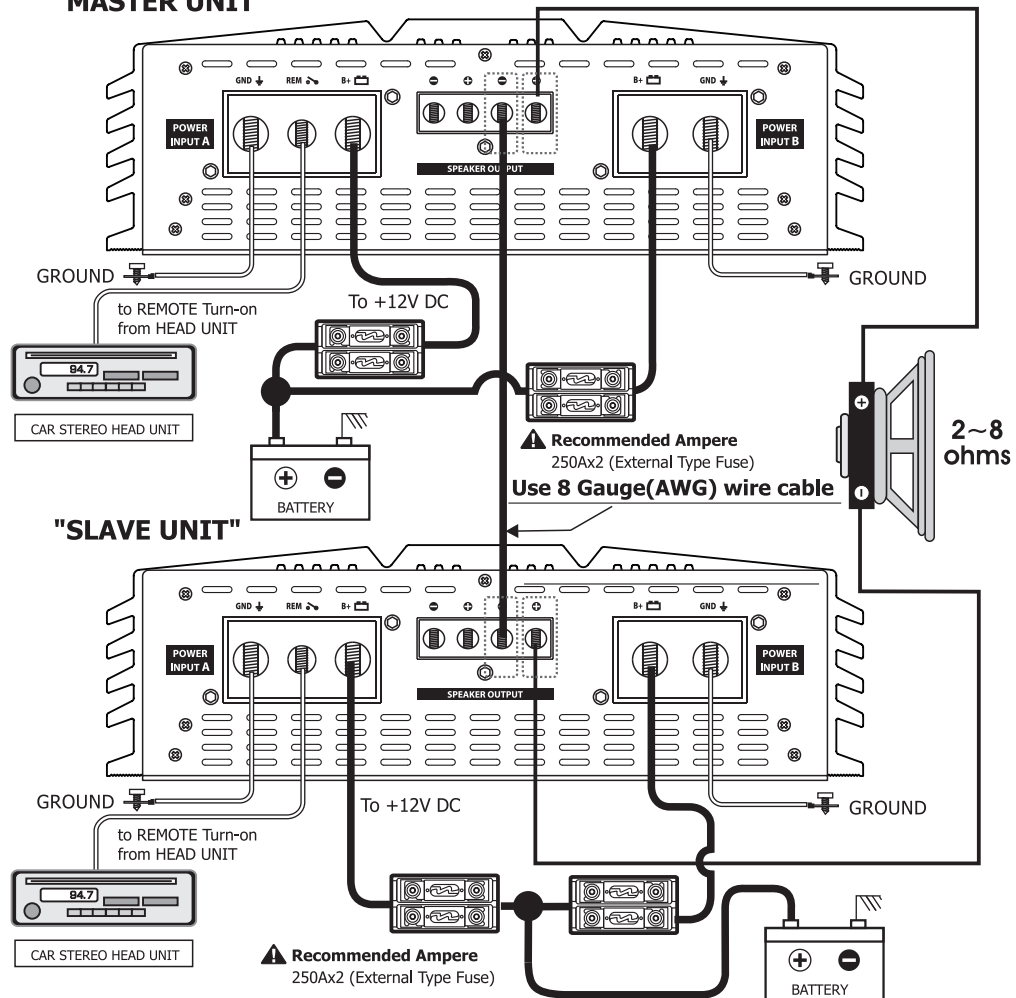

When using two amplifiers and strapping them together, the MASTER amplifier has total control over the SLAVE amplifier. When using two amplifiers to power a subwoofer, the positive terminal of the subwoofer's voice coil must be connected to the positive terminal of the MASTER amplifier. The negative terminal of the subwoofer's voice coil must be connected to the positive terminal of the SLAVE amplifier. You must then connect the two amplifiers together with an 8 gauge wire by hooking both negatives of each amplifier together, this along with the chaining the RCA's together on the bottom section of page 3 complete strapping. Incriminator Audio amplifiers strapped together create massive amount of power, please check the rating on your subwoofers to make sure there power handling is not exceeded."

### ⚠ Caution

In strapped mode your total impedance must be at least 2 ohms, any impedance less than 2 ohms could possibly damage your amplifiers

## TROUBLE SHOOTING

*This power amplifier has protection features to prevent any damages from misuse or faulty conditions. If the unit senses excessive heat, short circuited speakers or overload, the protection indicators will light, and the system will be turned off. In order to check the occurred problem, you should turn all levels down and all power off and carefully check the installation for wiring mistakes or short. If the amplifier shuts down due to excessive heat, the protection indicators will not light : simply allow time for the unit to cool.*

*Before removing your amplifier, refer to the list below and follow the suggested procedures. Always test the speakers and their wires first.*

### **AMPLIFIER IS NOT POWERED UP**

- ◆ Check that there is battery power on the +12V terminal.
- ◆ Check that remote terminal has at least 13.8V DC remote connection.
- ◆ Check a good ground connection. Check all fuses.
- ◆ Check the protection LED is not lit.

### **PROTECTION LED ILLUMINATES WHEN AMPLIFIER IS POWERED UP**

- ◆ Check shorts on speaker wires.
- ◆ Remove speaker wires and reset the amplifier. If the protection LED still comes on, then the amplifier is faulty.

### **FUSE BLOWING**

- ◆ Check that the minimum speaker impedance is correct.
- ◆ Check short on power cable and vehicle chassis.

### **OVERHEATING**

- ◆ Check that the minimum speaker impedance is correct.
- ◆ Check speaker shorts.
- ◆ Check that there is a good airflow around the amplifier.

### **SOUND TOO LOW-DISTORTED SOUND**

- ◆ Check that the input level control is set to match the output level of the unit.
- ◆ Check the head unit volume.
- ◆ Check speaker shorts.
- ◆ Check that crossover frequencies have been properly set.

### **HIGH HISS-ENGINE NOISE IN SPEAKERS**

- ◆ Check a good ground and for speaker shorts.
- ◆ Disconnect all RCA inputs from the amplifier. If hiss/noise disappears, check it with a good RCA interconnect. Then check the component driving the amplifier.



© Copyright 2010, Incriminator Audio, LLC. All Rights Reserved.